

Service Manual



Flexmobil i6

SitRite

Comfort

Comfort 2

Kameleon

*Euro*vema

<u>Contents</u>	Page
Replacing batteries	4
Replacing castors	5
Replacing drive wheel	6
Replacing drive motor 7-8	
Replacing lifting pillar	9
Replacing seat tilt actuator	10
Replacing adjustable back actuator	11
Circuit diagram, PG R-Net	12
Circuit diagram, Dynamic LINX	13- 14
Fault codes, PG-R-Net	15
Fault codes, Dynamic LINX	16
Technical data, Flexmobil i6	17
Exploded view, chassis	18
Spare parts list, chassis	19-20
Exploded view, Comfort seat	21
Spare parts list, Comfort seat	22-23
Exploded view, Comfort seat V2	24
Spare parts list, Comfort seat V2	25
Exploded view, seat frame, Comfort seat V2	26
Exploded view, back hinge, Comfort seat V2	27
Exploded view, slide back, Comfort seat V2	28
Exploded view, SitRite	29
Spare parts list, SitRite	30
Exploded view, multi-back	31
Spare parts list, multi-back	32
Kameleon seat	33

<u>Contents</u>	Page
Kameleon support cushions, thigh	35
Kameleon knee support	36
Kameleon hip support	37
Kameleon back frame	38
Kameleon back panel, upper	39
Kameleon back panel, upper, spare parts list	40
Kameleon back panel, centre	41
Kameleon back panel, centre, spare parts list	42
Kameleon back panel, lower	43
Kameleon back cushions	44
Kameleon armrests	45
Kameleon leg rests/foot rests	46
Reconditioning instructions	47-48
Checklist, reconditioning/destruction instructions	49-50
Notes	51

Replacing batteries

1. Turn off the main switch. 2. Remove the battery cover 3. Release the tension straps 4. Disconnect the cable connectors from the power module and ISM, and lift off the protective cover. 5. Disconnect the battery cables from the terminals, starting with the negative cable (-) 6. The cables are marked +1, +2, -1, -2. When refitting, follow the connection diagram attached to the inside of the cover. Start with + cables. Refit the remaining items in reverse order.

Follow the safety procedures set out below.

Use protective gloves. Do not wear armbands, watches, or rings made of metal when working on the electrical system of an electric wheelchair as there is a risk of short circuiting, which may result in serious burn injury.

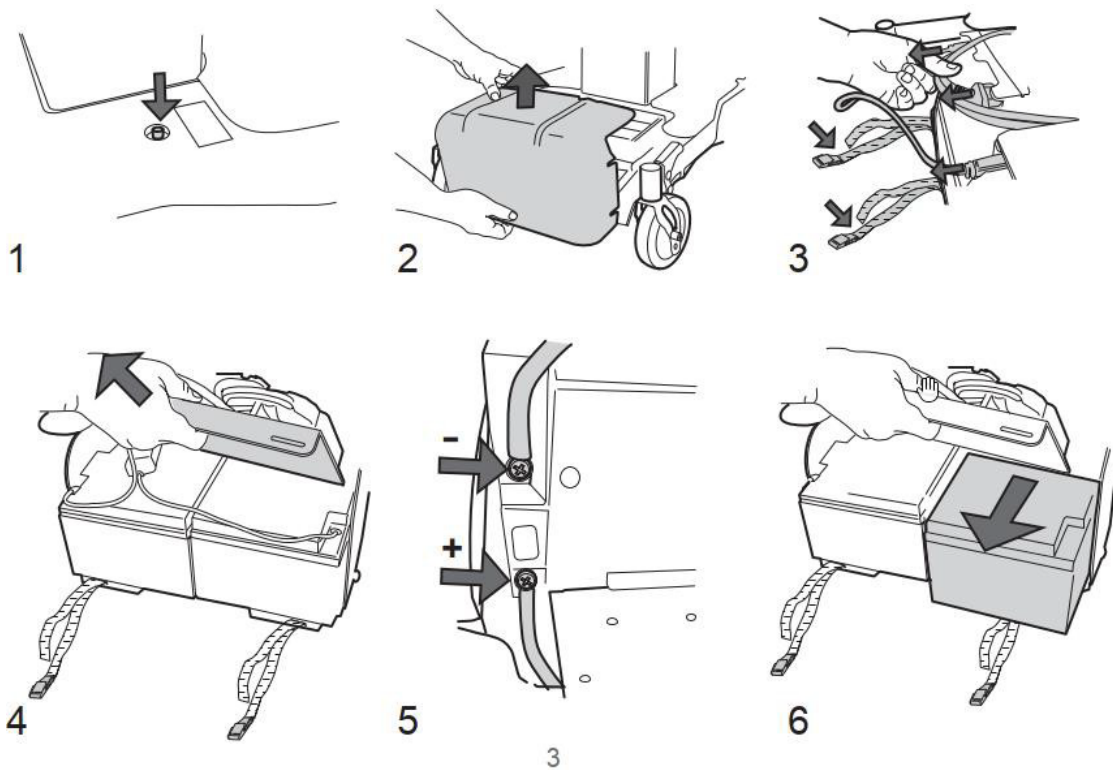

Replacing castors

Place a wooden chock or similar under the link arm to relieve pressure on the wheel. **2.** Undo the wheel bolt using a 5mm Allen key and a 13mm fixed spanner. **3.** Remove the bolt and lock nut, take off the wheel, and replace or clean it. Always fit a new bolt and lock nut. **5.** Tighten the bolt/nut securely, test that the wheel can rotate freely.

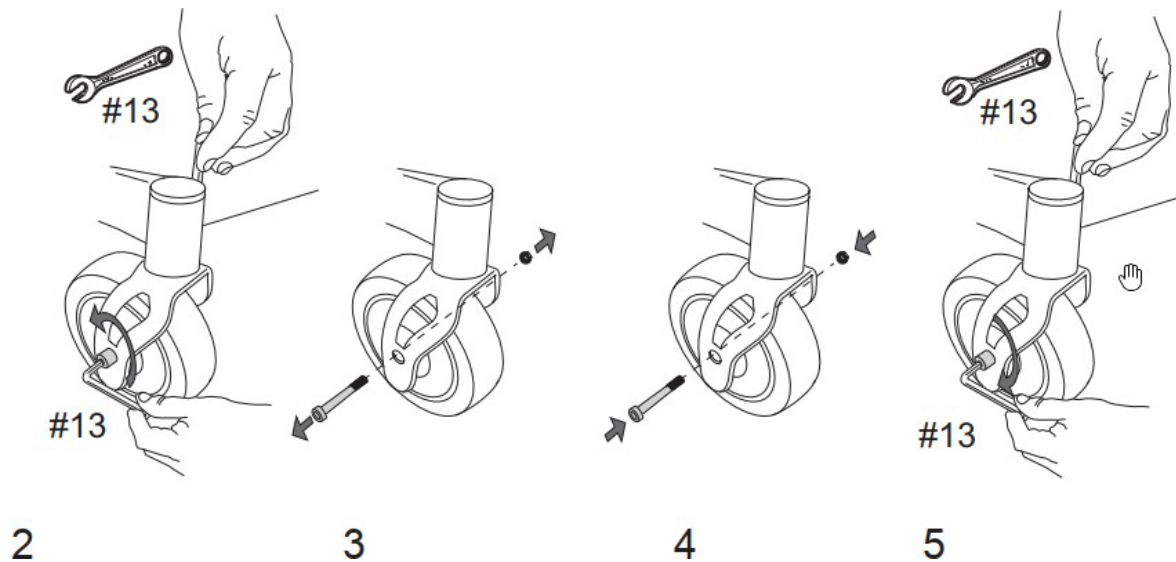

Replacing wheel fork

Lift the plastic protector using a screwdriver or similar. Unscrew the bolt from above using a 5mm Allen key, applying resistance with a 17mm articulated socket from below. Fit a new fork/bearing and refit the plastic protector.

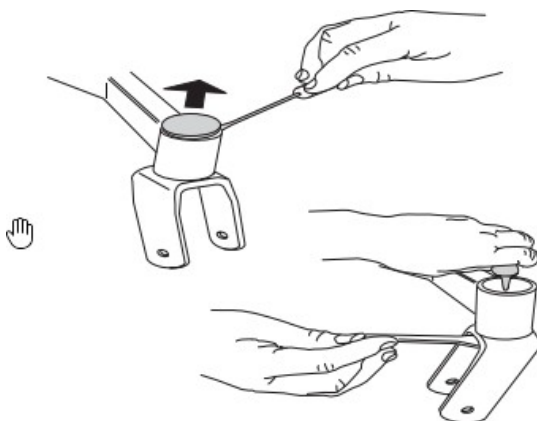

Replacing drive wheel

Place a wooden chock or similar under the chassis to relieve pressure on the wheel, making sure that the chassis is stable. **1.** Heat the bolts using a hot air gun or a small gas-powered blow torch, and undo the bolts using a 3mm Allen key. **2.** Remove the wheel and replace with a new one. Apply thread lock (e.g. Loctite 243) to the bolts, re-fit and tighten.

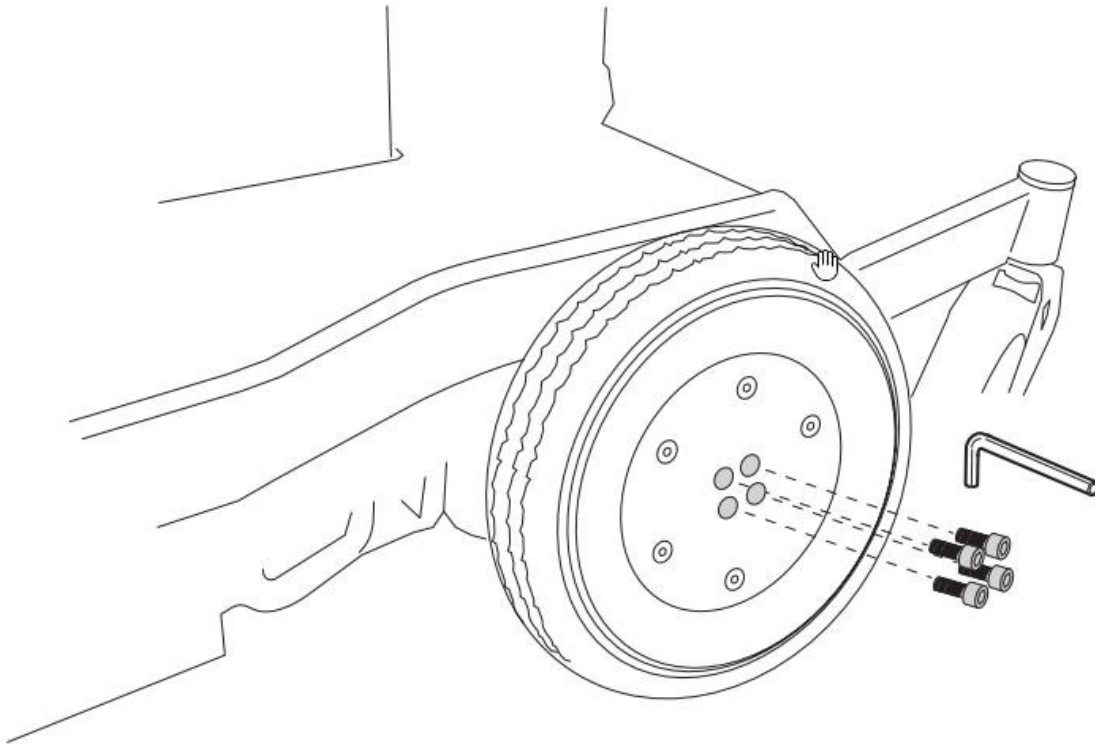

Replacing drive motor

1. Place the chassis on chocks and make sure that it is stable. **2.** Remove the battery cover and the front cover; see illustrations. **3.** Disconnect the motor contact from the power module.

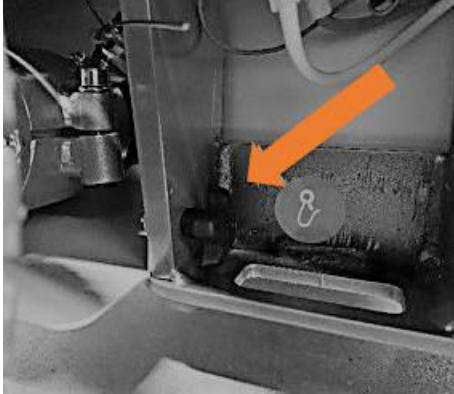

4. Remove the drive wheel. See page 6 for instructions how to do this. **5.** Undo the screws holding the cable tensioner bracket on the motor to be replaced. The threads of these screws are sealed using loctite, so heat them before undoing. **6.** Remove the magnetic brake fork (two nuts, 8mm spanner) as shown in the illustration. This must be removed in order to allow the motor to pass through the bracket in the frame.

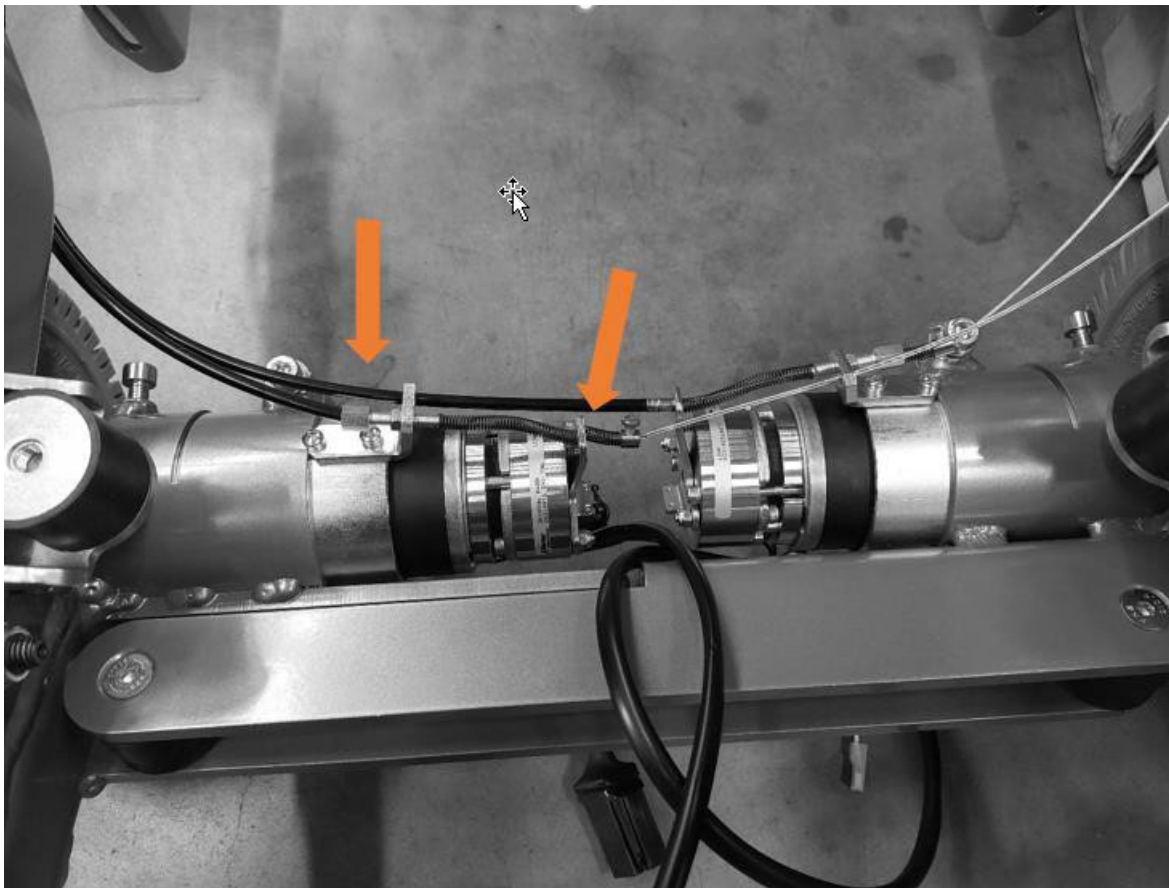

Replacing drive motor (cont.)

7. Loosen the two hexagonal screws holding the motor bracket a few turns using a 6mm Allen key to release the motor. 8. Pull the motor out from the motor bracket and replace with a new motor. 9. Refit the cable tensioner bracket using locktite and the brake fork. NB When refitting the fork, it is **important that there is a 0.20mm gap between the two nuts and the fork** in order for the brake to work correctly, then turn the motor so that they sit correctly as shown in the figure on page 6. 10. Securely tighten the hexagonal screws on the motor bracket using a 6mm Allen key. 11. Refit the drive wheel and apply loctite 243 (or equivalent) on the screws. 12. Test the magnetic brake, release, and try to manually move the chair. Connect the brakes and test operate the chair. Refit the covers.

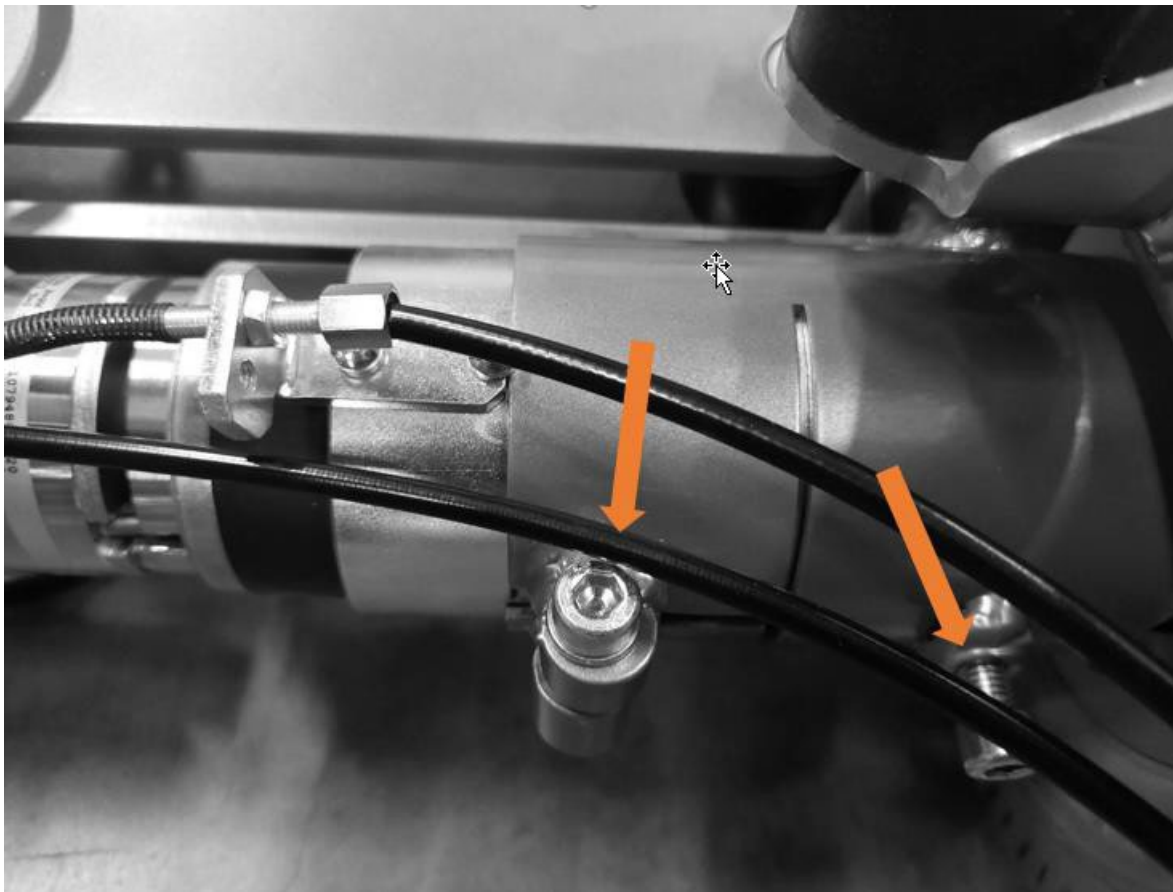

Replacing lifting pillar

1. Disconnect the cabling that connects the seat system to the chassis. **2.** Remove the seat, which is held in place by six M6x16 screws, from the seat cross using a 5mm Allen key. **3.** Undo the upper part of the seat cross as shown in the figure using two 19mm articulated/ring spanners, and pull out the shaft. On later models, the entire seat cross may be removed from above using a Torx tool as shown in Figure 2. **4.** Make sure that batteries and electronics are secured or removed, then turn the chassis on its side to access the four torx screws from the underside as shown in Figure 3.

Fit the new pillar and seat unit by repeating the steps of this procedure in reverse order.

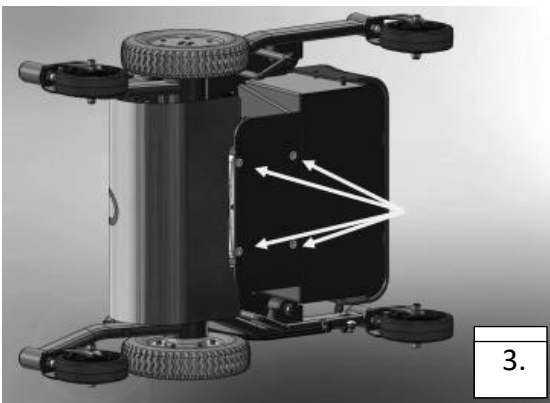
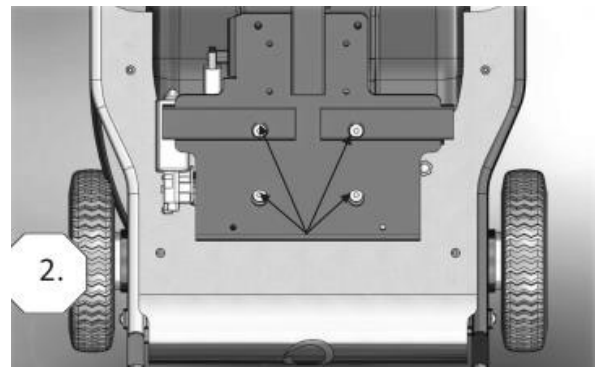
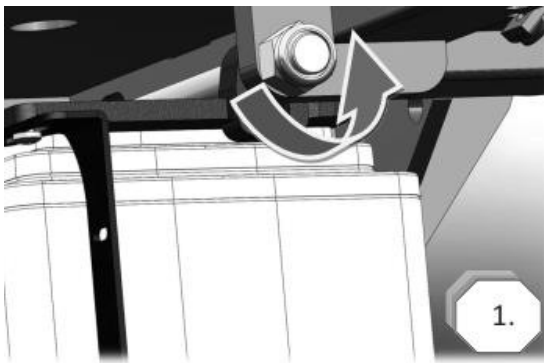

Replacement of seat tilt electronic actuator

1. Split the connector, 2. Undo the screws in each bracket using a 3mm Allen key and pull the actuator off the shaft pins. **Take care when removing the actuator as the seat will drop to the seat cross end position, potentially resulting in crush injury.**
3. Fit the new actuator by repeating the steps of this procedure in reverse order.



Replacement of manual tilt, crank and turnbuckle

1. Loosen the screws using a 3mm Allen key. **Take care when removing the actuator as the seat will drop to the seat cross end position, potentially resulting in crush injury.** 3. Fit the new actuator by repeating the steps of this procedure in reverse order.

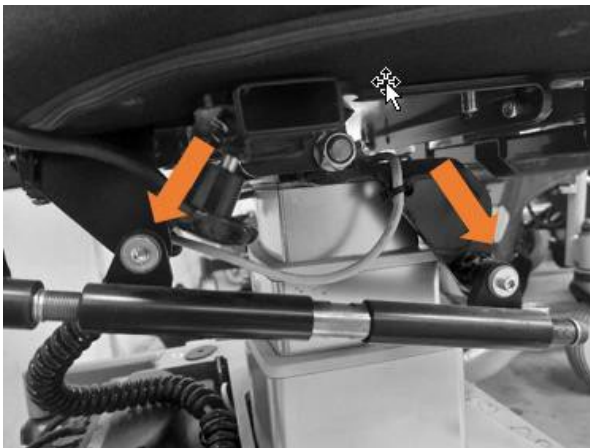

Replacement of electronic actuator, Comfort seat back tilt

1. Disconnect the electronic actuator connector. **2.** Loosen the screws using a 3mm Allen key. **The back support will fall backwards once the actuator is removed from the shaft pins if it is not held in position.** **3.** Fit the new actuator by repeating the steps of this procedure in reverse order.



Replacement of back tilt electronic actuator, SitRite

1. Disconnect the electronic actuator connector. **2.** Undo the two screws holding the actuator using a 3mm Allen key. **3.** Pull the electronic actuator off the shaft pins. **4.** Fit the new actuator by repeating the steps of this procedure in reverse order.



Circuit diagram, PGDT R- NET

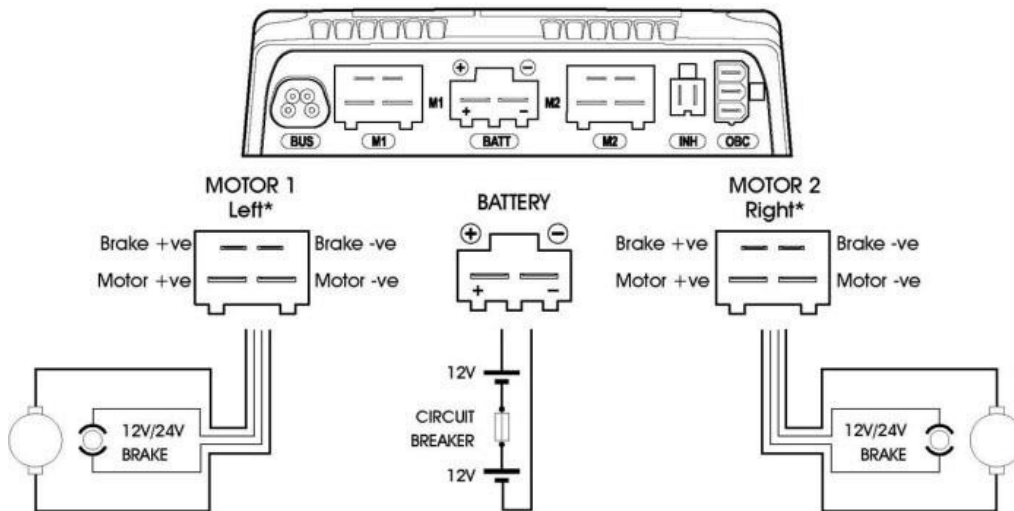
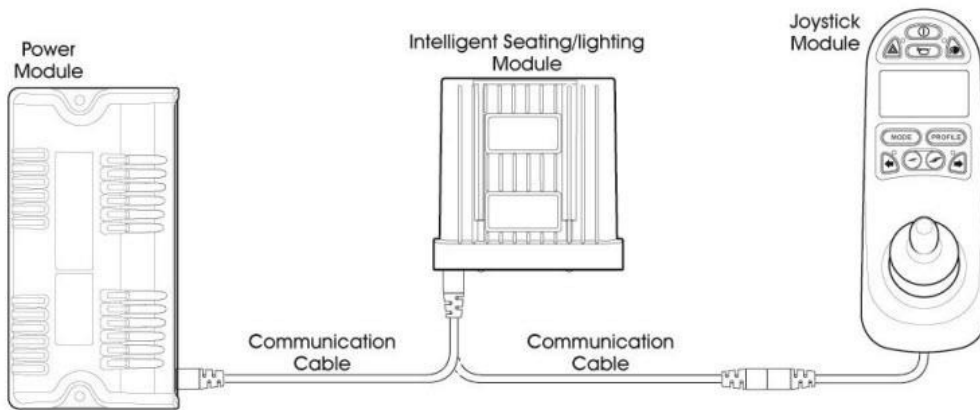

Actuator channel

1 seat lift 2 seat tilt 3 back tilt

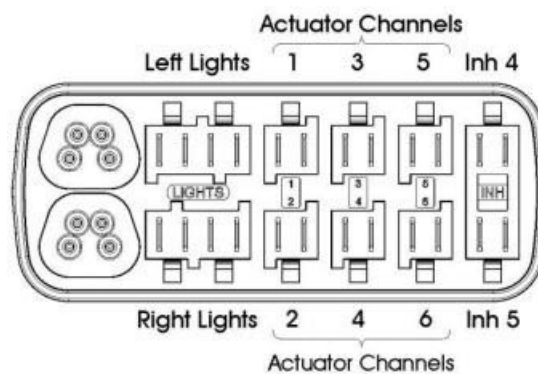

Circuit diagram, Dynamics LINX

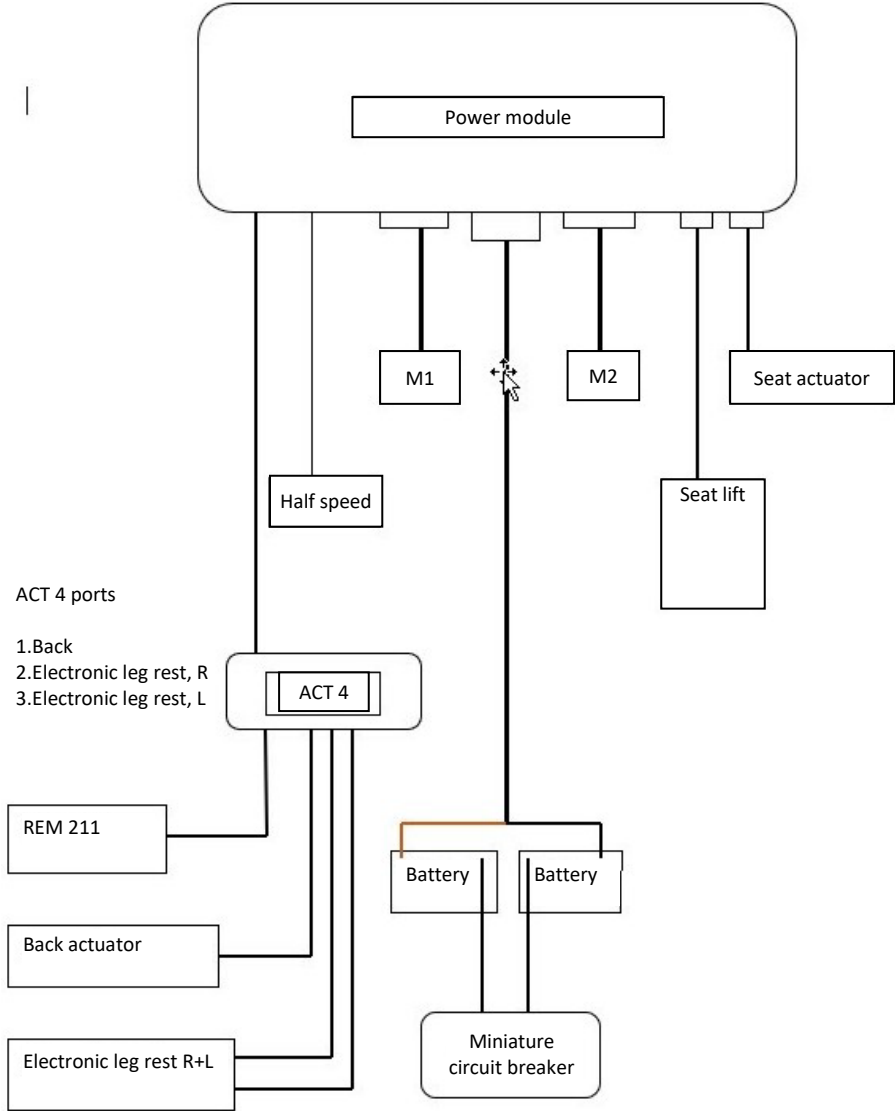

Circuit diagram, Dynamic LINX

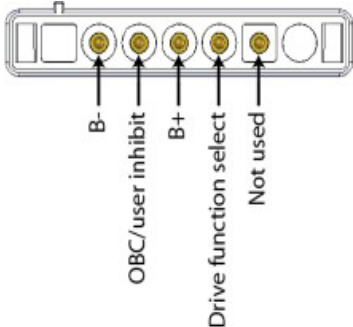
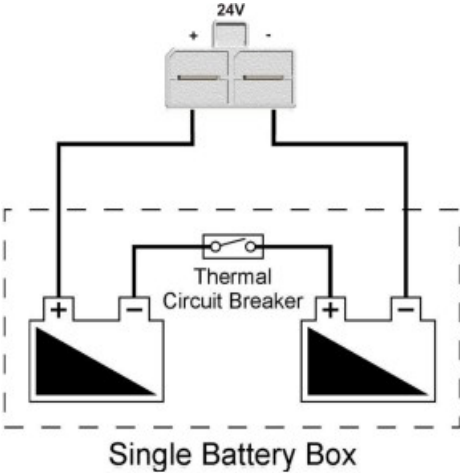

Figure 24: The utility connector

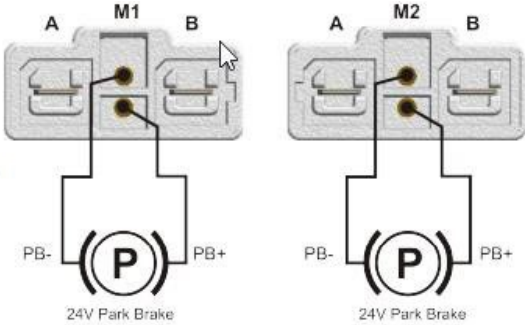













Figure 20: Two 24 V park brakes

Fault codes, R-NET

1 LED 	The battery needs charging or there is a bad connection to the battery. Check the connections to the battery. If the connections are good, try charging the battery.
2 LEDs 	The left hand motor* has a bad connection. Check the connections to the left hand motor.
3 LEDs 	The left hand motor* has a short circuit to a battery connection. Contact your local service agent.
4 LEDs 	The right hand motor* has a bad connection. Check the connections to the right hand motor.
5 LEDs 	The right hand motor* has a short circuit to a battery connection. Contact your local service agent.
6 LEDs 	The wheelchair is being prevented from driving by an external signal. The exact cause will depend on the type of wheelchair you have.
7 LEDs 	A joystick fault is indicated. Make sure that the joystick is in the centre position before switching on the control system.
8 LEDs 	A possible control system fault is indicated. Make sure that all connections are secure.
9 LEDs 	The parking brakes have a bad connection. Check the parking brake and motor connections. Make sure that the control system connections are secure.
10 LEDs 	Excessive voltage has been applied to the control system. This is usually caused by a poor battery connection. Check the battery connections.
7 LEDs + S 	A communication fault is indicated. Make sure that the joystick cable is securely connected and not damaged.
Actuator Flash 	An actuator trip is indicated. If more than one actuator is fitted, identify which actuator is not working correctly. Check the actuator wiring.



Fault and diagnostic codes, LINX

If there is a fault in the system when it is started, the status light will flash red. You can diagnose the fault using the following troubleshooting guide. The number of flashes indicate the type of fault. The electronic drive system must be turned on before you start troubleshooting.

Light code	Fault	Action
1	Fault in operation box	<ul style="list-style-type: none">• Check cables and connections.• Contact your supplier
2	Network or configuration fault	<ul style="list-style-type: none">• Check cables and connections.• Charge the batteries.• Check the charger.• Contact your supplier
3	Fault in left hand motor	<ul style="list-style-type: none">• Check cables and connections.• Contact your supplier.
4	Fault in right hand motor	<ul style="list-style-type: none">• Check cables and connections.• Contact your supplier.
5	Fault in left hand magnetic brake	<ul style="list-style-type: none">• Check cables and connections.• Check that left hand magnetic brake is activated.• See the chapter “RELEASING BRAKES” in the manual.• Contact your supplier.
6	Fault in right hand magnetic brake	<ul style="list-style-type: none">• Check cables and connections.• Check that right hand magnetic brake is activated.• See the chapter “RELEASING BRAKES” in the manual.• Contact your supplier.
7	Module fault	<ul style="list-style-type: none">• Check cables and connections.• Check the modules.• Charge the batteries.• If the wheelchair has stopped, you can reverse or remove the obstacle.• Contact your supplier,

Technical data, chassis

Class	A
Chassis width	570mm
Chassis length	800mm
Total weight	90kg
User weight, max.	150kg
Turning circle	1100mm
Static stability F/B/S	6°/6°/6°
Dynamic stability, upwards	3°
Dynamic stability, downwards	3°
Dynamic stability, lateral	3°
Obstruction clearance	30mm
Ground clearance	40mm
Drive wheel	2.8/2.5-4 NHS
Castors	125mm
Batteries	Discover 24Ah GEL (YUASA 24Ah)
Max operation time	6-8h
Energy consumption, continual operation, straight	26.3 Wh/km
Energy consumption during operation	56.8 Wh/km
Estimated range, continual operation, straight	35.0 km
Estimated range during operation	16.2 km
Electronics	Dynamic LINX/PGDT R-NET
Max speed	4.7 km/h
Charging time	6-8h

Exploded view, chassis i6

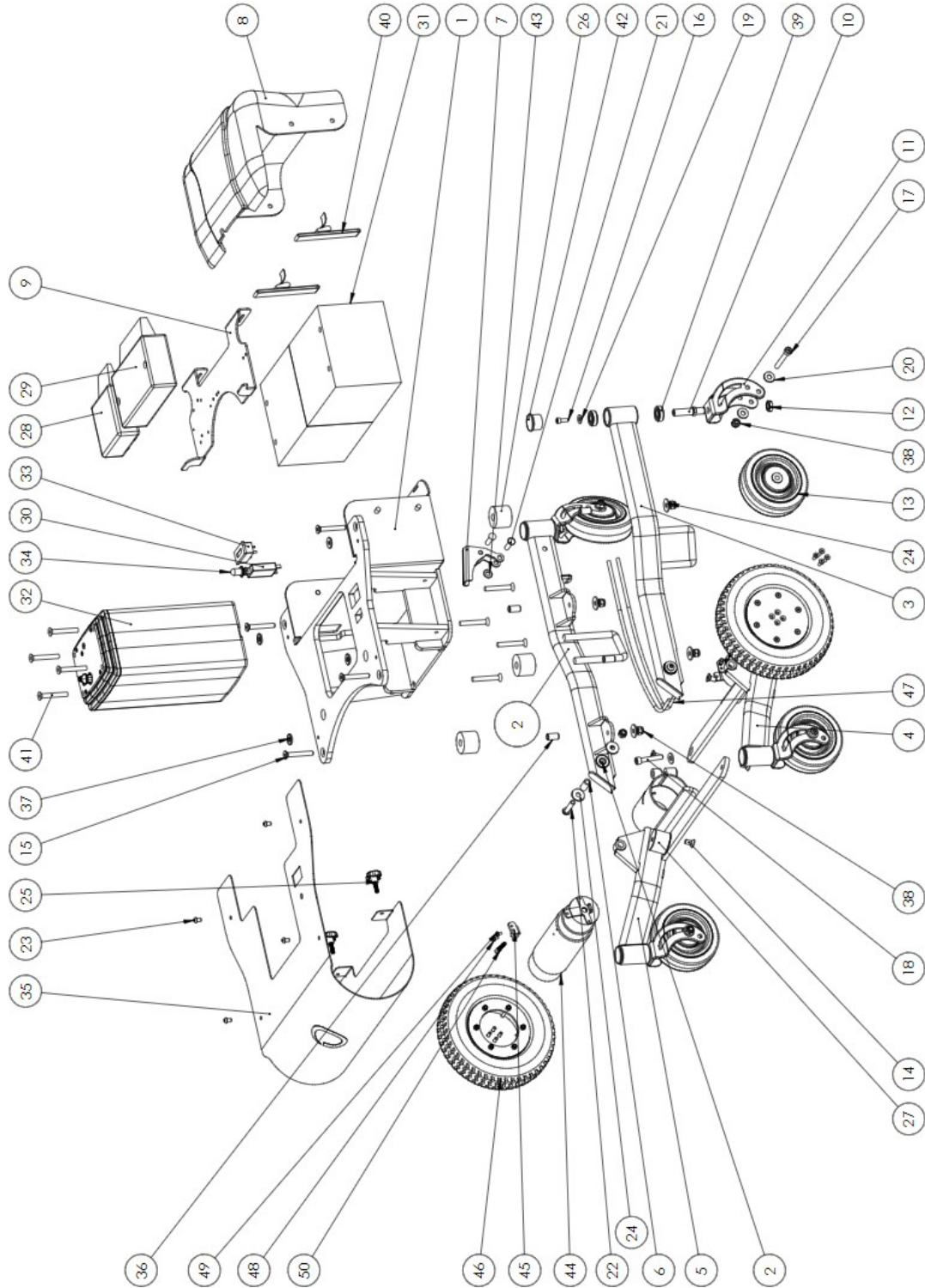

Spare parts list, chassis i6

Spare part	Part number
1. Pillar centre	SW-0195
2. Link arm, rear, right	SW-02014
3. Link arm, rear, left	SW-02012
4. Link arm, front, right	SW-02011
5. Link arm, front, left	SW-02009
6. Articulated bush	SW-01900
7. Release lever	SW-01901
8. Battery cover	669002-9000
9. Electronic plate	SW-01899
10. Shaft pin	669001-11
11. Wheel fork	SW-01898
12. Nut M12x1.25	7M6M-M12x1.25
13. Front/rear wheel 125mm	769002-7000
14. Countersunk screw M8x16	7F6S-8x16
15. Countersunk screw M8x55	7F6S-8x55
16. Screw with flange M6x16	7MC6sf-6x16
17. Hexagon head screw M8x60	7MLC6S-8x60
18. Screw M8x45	7MLC6S-8x45
19. Rivet washer M6x16	7NB-6x16
20. Flat washer M8x16-20	7BRB-8.4x16
21. Steel rivet 8x30	7KN-8x30
22. Screw, black M8x40	7K6S-8x40
23. Screw, galv. M6x10	7K6S-6x10R
24. Rivet washer M8x20-25	7NB-8x25
25. Wheel M6x20	7RATT-M6x20
26. Damper 40x13x30	769002-1000
27. Vibration damper 40x30xM8	7VIBRA-40x30
28. ACT400	7DLX-ACT400A
29. Power module LINX 75Amp	7DLX-PM75AL-B
30. Circuit breaker	7AFUSE-20A
31. Battery YUASA NPC12-24	7YAZ4-12
32. Battery Discover EV512G-020	7EV512G-020
33. Lifting pillar	669002-8000
34. Operating time meter	7DRIFTTIDSM
35. Sealing cap, main switch	
36. Front cover, plate	SW-02016

Spare parts list, chassis

Spare part	Part number
37. Rubber damper	SW-02007
38. M8 lock nut	7LOCKING-M8L
39. Ball bearing	7K6001-2Z
40. Tension strap	7BB-1500
41. Screw, pillar, torx 8x60	7WN1543-8x60
42. End terminal 32x28	7SFL+32
43. Starlock 8mm	7671-8
44. Drive motor	269102-1103H/V
45. Cable bracket	669201-1001
46. Drive wheel	269003-1110
47. Cable	669201-1800
48. Screw M4x8	7MRX-4x8
49. Washer	7FBB-4.1x7.6
50. Adjuster screw M5x25	769201-1400
51. Cable, lifting pillar	669002-8100
52. Cable lock	669002-8200

Exploded view, Comfort seat

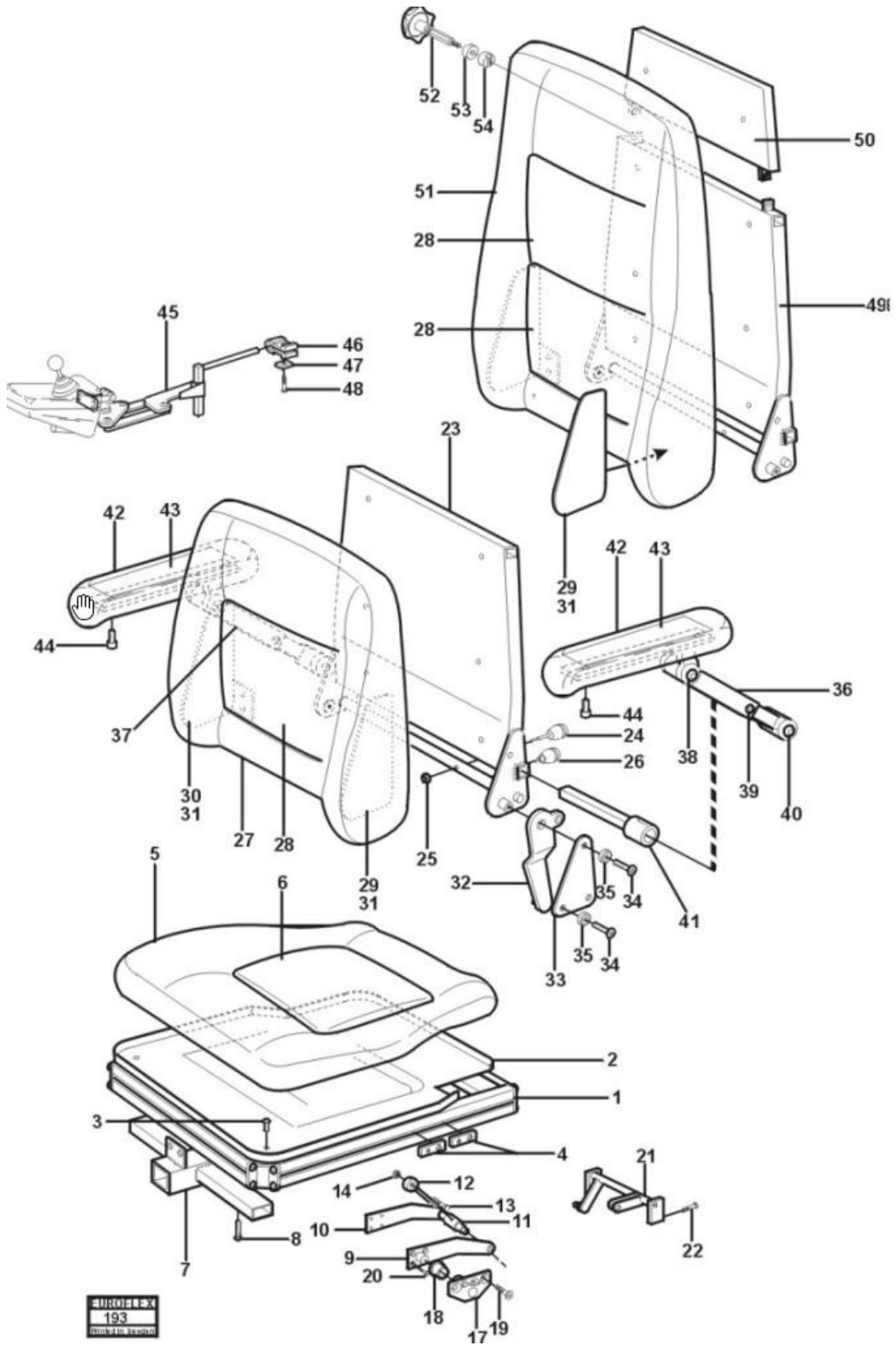

Spare parts list, Comfort seat

Spare part	Part number
1.a Seat alu. profile, side	Withdrawn
1.b Seat alu. profile, front	Withdrawn
1.c Comfort seat, new	699101-3001
2. Comfort seat, plastic plate	699101-3001
3. Screw M5x12	7k6s-5x12
4. Nut plate, DX alu. seat	699001-3010
5.a Seat upholstery	699103-3008
5.b Comfort seat foam	699103-3011
6.a Upholstery cover, cushion	699102-3003
6.b Seat cushion, foam	699102-2011
7. Combi mounting for leg rest	699001-2011
8. Screw M8x20, rounded hexagonal head	7k6s-8x20
9. Tilt fitting, left	Tilt fitting, left
10. Tilt fitting, right	Tilt fitting, right
11. Tilt articulation shaft	357001-4300
12. Link screw	7lanksM10x100
13. Screw spec. M10x35	
14. Mutter M10 lock	7kl-6-10
17. Baffle plate	
18. Polyamide bushing	7polyb-20x25
19. Screw M10x40, countersunk hexagonal head	7f6s-10x40
20. Screw M8x20, countersunk hexagonal head	7f6s-8x20
21. Tilt shaft, spare part	11230515-s
22a. Screw M5x12, countersunk hexagonal head	7f6s-5x12
22b. Bushing, lubricant-free	7tff-08075
23. Back, low	699102-6000
24. Locking pin M6x10	699101-6030
25. Mutter M5 lock	7kl-6-5
26a. Locking pin M6x30	699101-6031
26b. Knob	
27. Upholstery, low back	699103-6005
28a. Foam, low back	699101-6001
28b. Foam, back cushion	699102-6001
30. Side plate, left	
31. Side plate, right	
32. Fitting, back fold	
33. Fitting, back	
34. Screw M8x30, countersunk hexagonal head	7f6s-8x30
35. Cover washer	699001-9001

Spare parts list, Comfort seat

Spare part	Part number
36. Armrest, height adjustment, left	699001-4000V
37. Armrest, height adjustment, right	699001-4000H
38. Screw M8x30, rounded hexagonal head	7k6s-8x30
39. Screw M8x20, rounded hexagonal head	7k6s-8x20
40. Screw M8x35, rounded hexagonal head	7k6s-8x35
41. Armrest attachment, width adjustment	699001-40001
42. Armrests	(624001-4000)
43. Armrest insert	withdrawn
44. Screw M6x14, hexagonal head	7mc6s-6x14
45. Control box mounting	(
46. Clamp	624001-2012
47. Fixing plate 30x15x5	358001-6600
48. Screw M8x20, rounded hexagonal head	7k6s-8x20sk
49. Back, high	699202-6000
50. Back, high, upper section	399002-6001
51a. Upholstery, high, back	699202-6002
51b. Foam, high, back	699201-6001
52a. Wheel M8x16	7s-ratt-8x16
52b. Lock shaft	357001-7400
53. Gear lock	624001-9000
54. Gear lock	624001-9000 .

Exploded view, Comfort 2

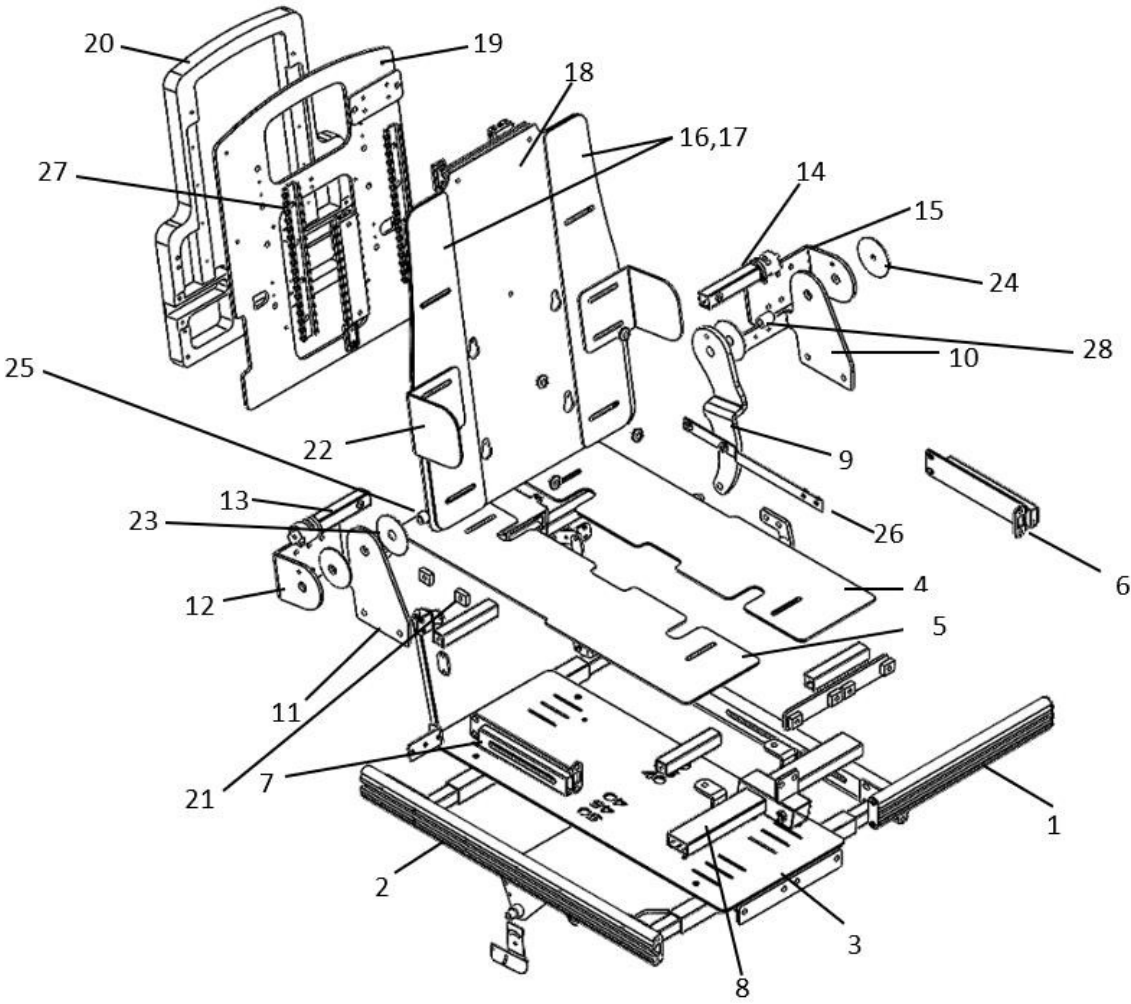

Spare parts list, Comfort 2

Spare part	Part number
1. Aluminium rail, front	00340072
2. Aluminium rail, side	00340011
3. Centre plate, seat	00340005
4. Side plate, seat	00340006
5. Side plate, seat	00340006
6. Leg rest adapter, Minicrosser electronic leg rest	SW-01210
7. Leg rest adapter, Minicrosser electronic leg rest	SW-01210
8. Leg rest attachment, centre mounted foot rest	300731
9. Angle bracket, back	00340029
10 am. Lower tilt fitting, back, left	00340031
11. Lower tilt fitting, back, right	00340030
12. Tilt fitting, back, right	00340028
13. Armrest attachment, right	00340080
14. Armrest attachment, left	00340045
15. Tilt fitting, back, left	00340027
16. Back plate widener, 500mm r+l	00340053
17. Back plate widener, 620mm r+l	00340079
18. Back plate 620mm	00340078
19. Slide plate, back	00340056
20. Back frame	00340051
21. Square nut, slide rail	003400
22. Trunk support plate	00340065
23. Plastic washer, back tilt fitting	00340035
24. Plastic washer, outer back tilt fitting	00340082
25. Bushing, back articulation, right	00340033
26. Nut rail for back actuator side rail	00340061
27. Slide rails, slide back NS-01-27	00340048
28. Bushing, back articulation, left	00340034

Exploded view, seat Comfort 2

2/4

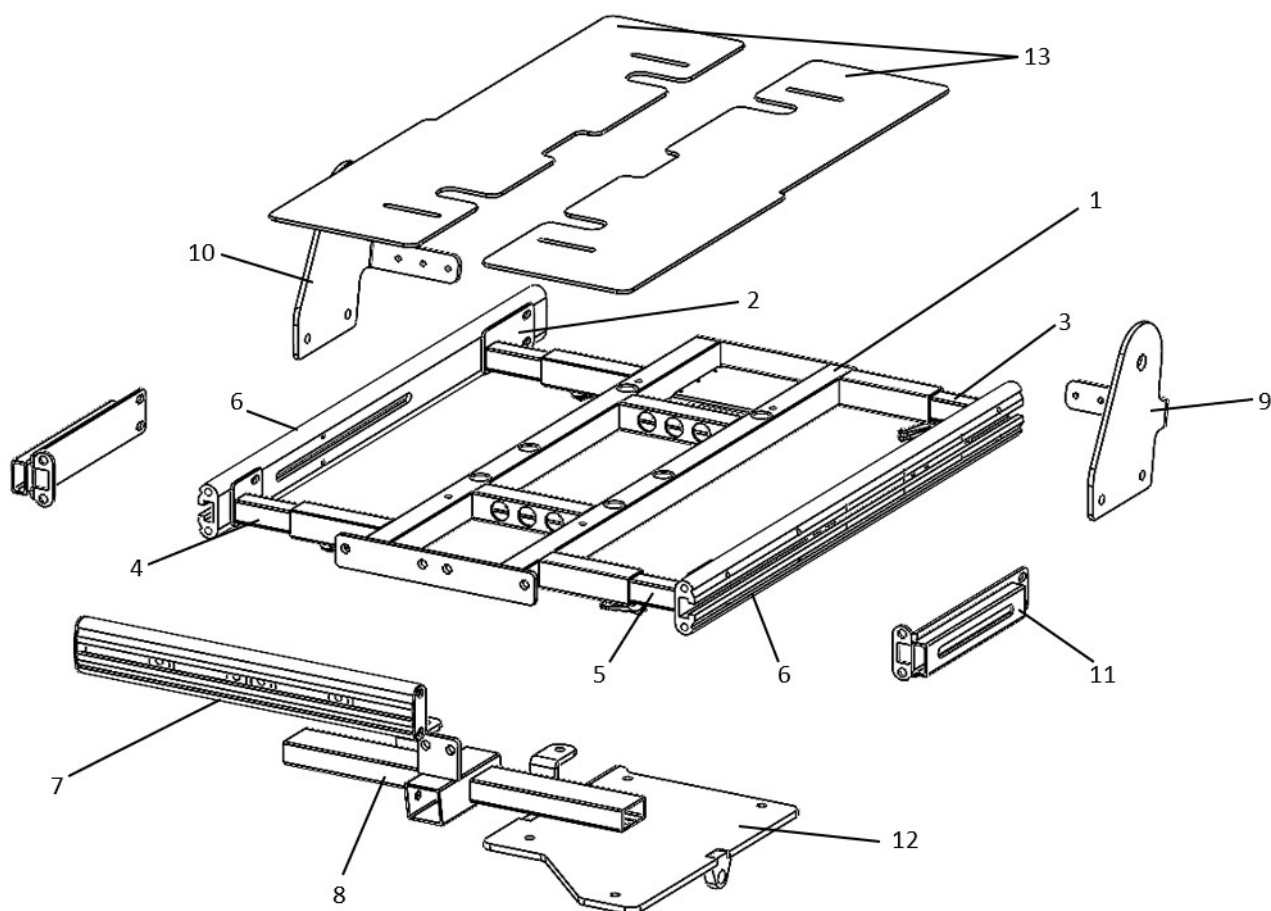

Spare parts

1. Seat frame
2. Rail attachment, expandable, right, rear
3. Rail attachment, expandable, left, rear
4. Rail attachment, expandable, right, front
5. Rail attachment, expandable, left, front
6. Aluminium rail, side
7. Aluminium rail, front
8. Leg rest attachment, centre mounted foot rest
9. Lower tilt fitting, back, left
10. Lower tilt fitting, back, right
11. Attachment, electric leg rest, Minicrosser right, left
12. Tilt plate
13. Side plate, seat, right, left

Part number

- 00340021
 00340014
 00340070
 00340012
 00340013
 00340011
 00340072
 300731
 00340031
 00340030
 SW-01210
 00340021
 00340006

Exploded view, back hinge/expansion fitting Comfort 2

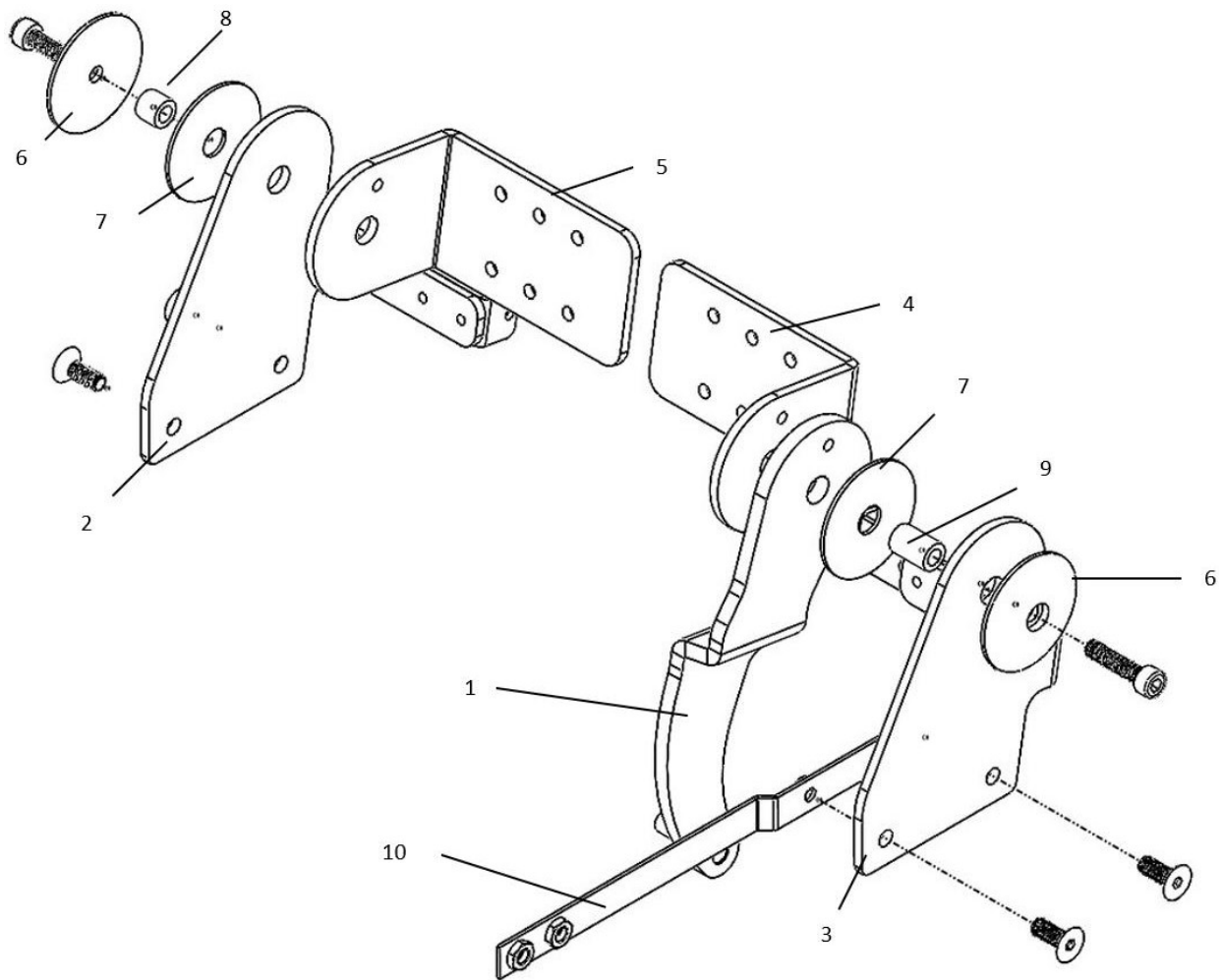

Spare parts

1. Tilt fitting, actuator attachment
2. Lower fitting, back articulation, right
3. Lower fitting, back articulation, left
4. Tilt fitting, back, left
5. Tilt fitting, back, right
6. Plastic washer, outer back tilt fitting
7. Plastic washer
8. Bushing, back articulation, right
9. Bushing, back articulation, left
10. Nut rail for side rail back/back actuator

Part number

- 00340029
- 00340030
- 00340031
- 00340027
- 00340028
- 00340082
- 00340035
- 00340033
- 00340034
- 00340061

Exploded view, slide back Comfort 2

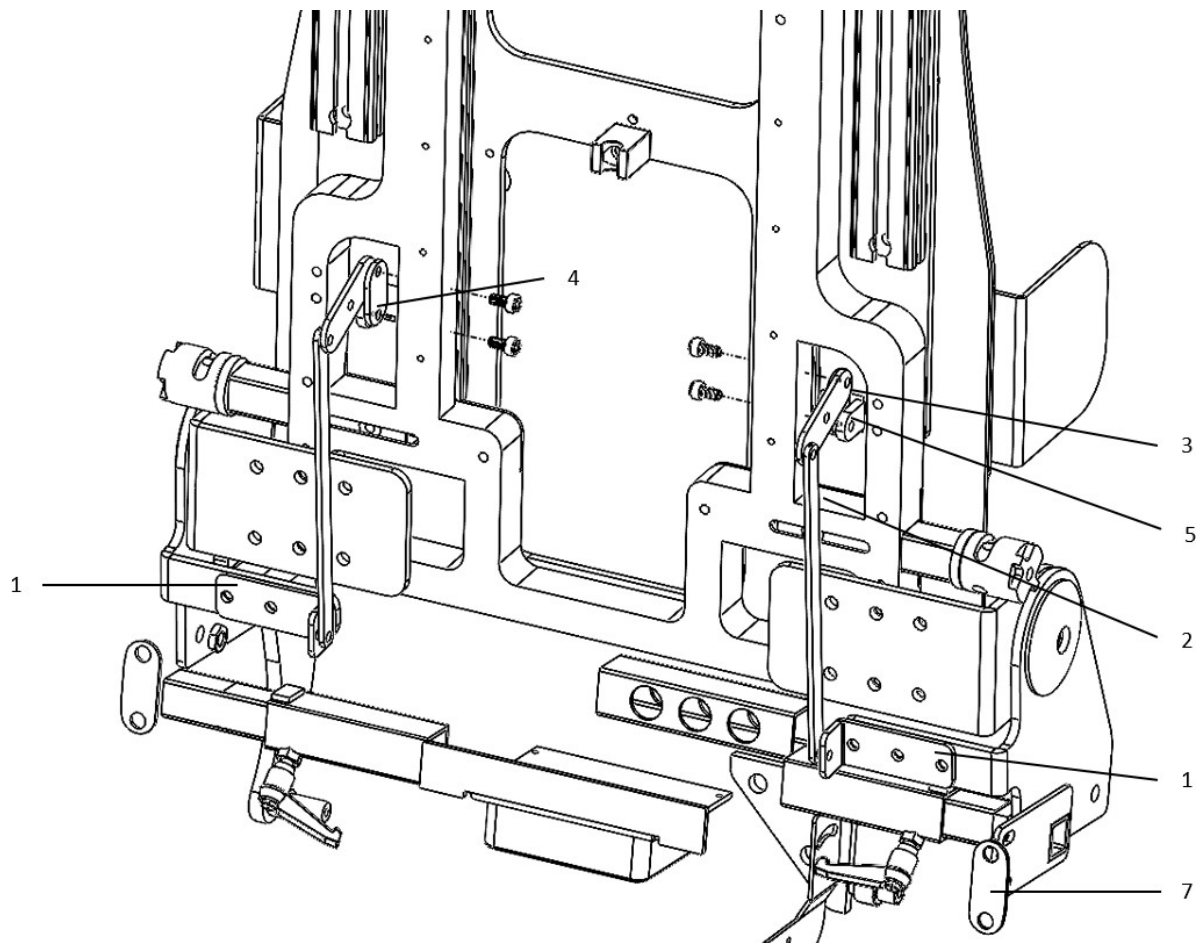

Spare part

- 1. Angle bar, slide back
- 2. Bar, slide back
- 3. Link plate
- 4. Link plate
- 5. Block, angle bracket
- 6. Cover, aluminium rail

Part number

- 00340036
- 00340038
- 00340039
- 00340040
- 00340041
- 00340037

Exploded view, SitRite

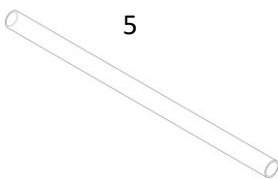
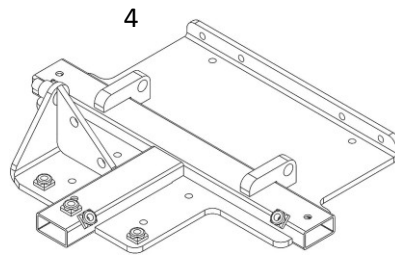
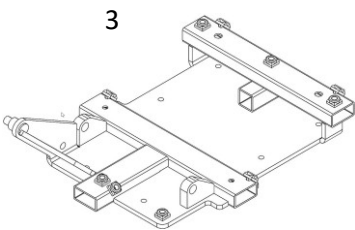
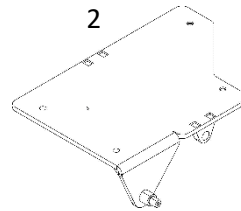
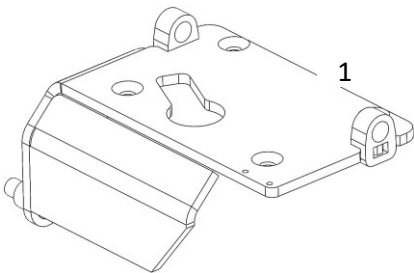
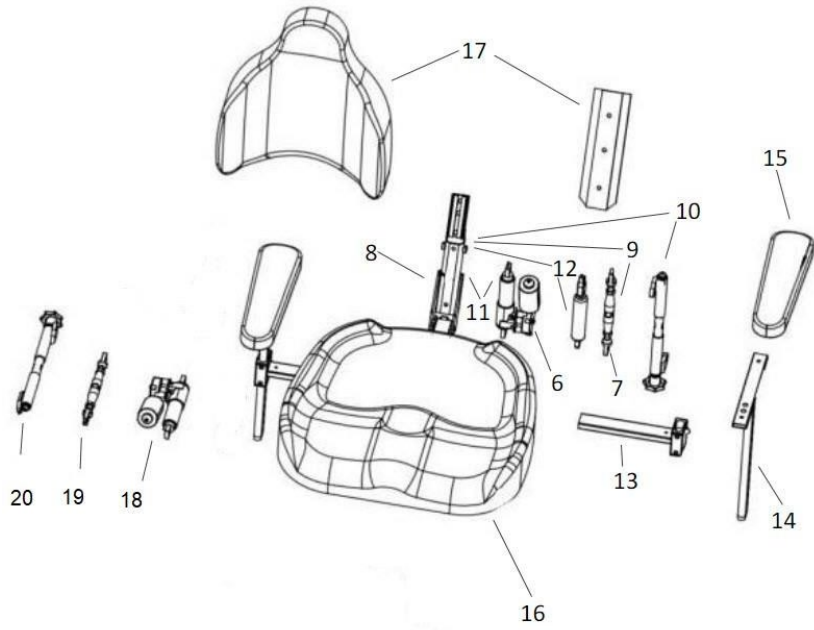

Spare parts list, SitRite

Spare part	Part number
1. Lower base attachment, Pillar cross	SW-01969
2. Upper plate, Pillar cross, comfort	SW-02026
3. Upper seat cross, Pillar cross, child	SW-02022
4. Upper plate, Pillar cross, adult	SW-01968
5. Shaft, seat cross pillar, I6	SW-01981
6. Actuator, multi-back, 24V 40mm	699102-8010
7. Back tilt, manual	229001-6008
8. Multi-back, component handled	227001-6200
9. Multi-back with manual setting	227001-6000
10. Multi-back with crank	227001-6100
11. Multi-back with electronic actuator 24V	227002-6100
12. Multi-back with gas adjustment	227003-6000
13. Width adjustment *short	634001-4012
14. Width adjustment, long for width 500mm	624001-4012K
15a. Armrest plate, soft 30x3	624002-4004
15b. Armrest plate, soft 30x5	624001-4004-S
15c. Armrest plate, soft 40x3	624002-4007
15d. Armrest plate, soft 40x5	624001-4007
16a. Seat, SitRite 40x40	624520-4040
16b. Seat, SitRite 40x45	624520-4045
16c. Seat, SitRite 45x45	624520-4545
16d. Seat, SitRite 45x50	624520-4550
16e. Seat, SitRite 50x50	624520-5050
17a. Back, SitRite 37x43	224525-3640
17b. Back, SitRite 37x43 conn. incl. Trunk support reinforcement	224525-3640-B
17c. Back, SitRite 37x43 conn. incl. Spinal curve support	224525-3640-S
17d. Back, SitRite 42x45	224525-4245
17e. Back, SitRite 42x45 conn. incl. Trunk support reinforcement	224525-4245-B
17f. Back, SitRite 42x45 conn. incl. Spinal curve support	224525-4245-S
17g. Back, SitRite 47x47	224525-4550
17h. Back, SitRite 47x47 conn. incl. Trunk support reinforcement	224525-4550-B
17i. Back, SitRite 47x47 conn. incl. Spinal curve support	224525-4550-S
18. Actuator 24V 40mm seat tilt	699102-8010
19. Tilt, manual	800010-1952
20. Tilt with crank	800010-1953

Exploded view, multi-back

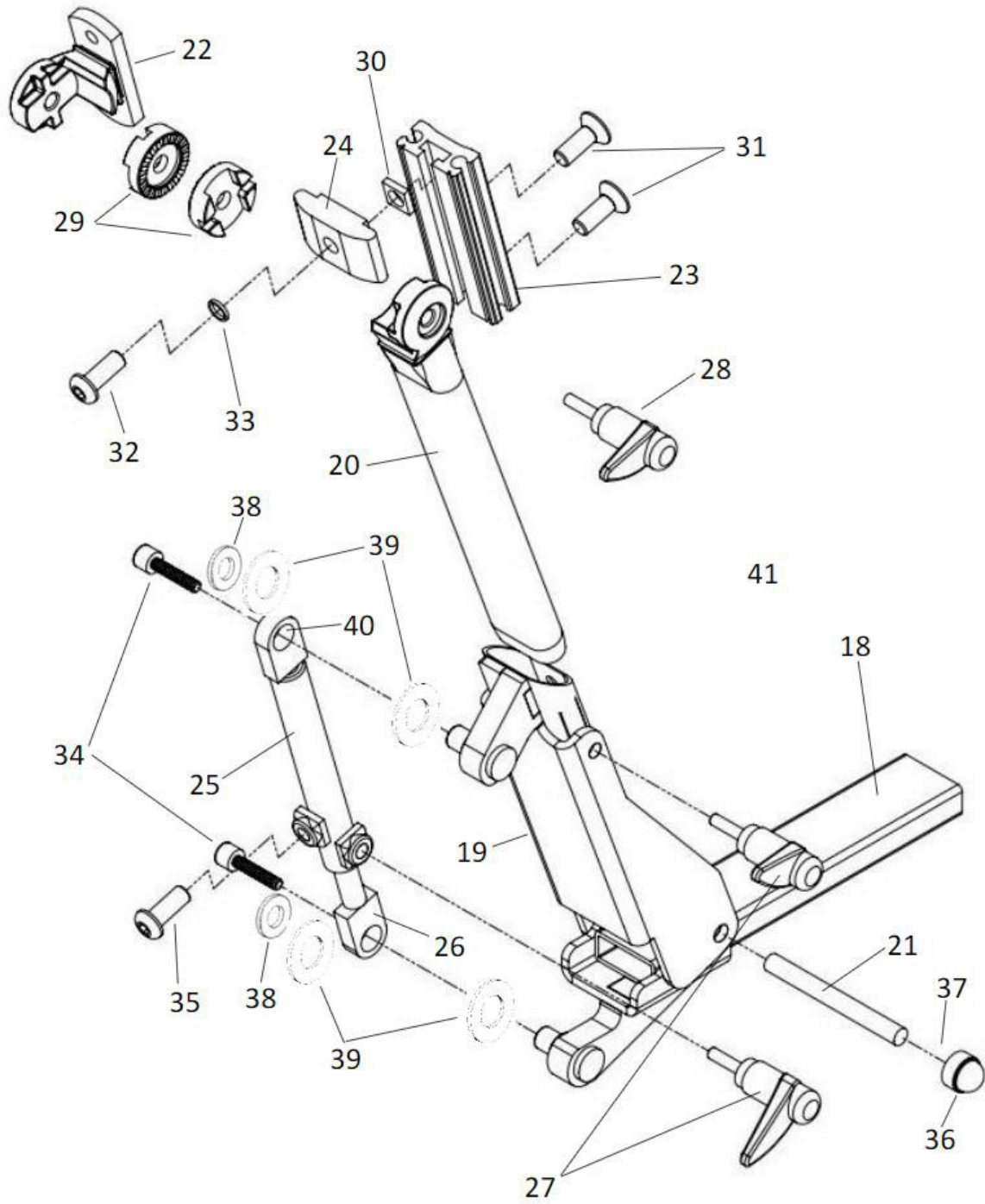

Spare parts list, multi-back

Spare parts	Part number
18. Back post, lower part	SW-01985
19. Back post, upper part	SW-01992
20. Back post, multi-back	SW-02034
21. Pin bolt M8	SW-01999
22. Profile attachment	274001-6005
23. Profile, back post ABC	674001-6004
24. Alu. profile lock wedge ABC	675002-4400
25. Adjuster device, back post	SW-01993
26. Adjuster device stay, back post	SW-01997
27. Lock lever WN500 65-M8x16	7WN5000-8x16
28. Lock lever MRX 63p-M8x30	7MRP 63-8x30
29. Gear lock	624001-9000
30. Square nut M8 FZB	7ML4M-8
31. Screw MF6S-M8x22 FZB	F6S-M8x22 FZB
32. Screw K6S-8x25 black chrome	7K6S-8x25
33. Flat washer 8.4x16x1.5 black chrome	BRB-8.4x16 SK
34. Screw MC6S-M5x10FZB, LOCKTITE	7MC6S-5x10 LOCK
35. Screw, rounded head K6S M8x12 black chrome	7K6S-8x12
36. Nut protector M8	7KH-13-8
37. Locking nut M8 DIN 985 FZB	7LOCKING-M8L
38. Washer 5.3x10x1 FZB	7BRB-5.3x10
39. Plastic washer 10.5x18x1.0	7PLASTB-10.5x18
40. Dry star lubricant-free bushing 10x12x8	7BM-1008-FB
41. SPR. LOCK 6x80 SING. RIVETED	2FJL-6x80E

No.: 19, 21, 22, 23, 27, 28, 29, 30, 31, 32 forms 227004-6000 back post, multi-back/base

Exploded view, seat frame Kameleon

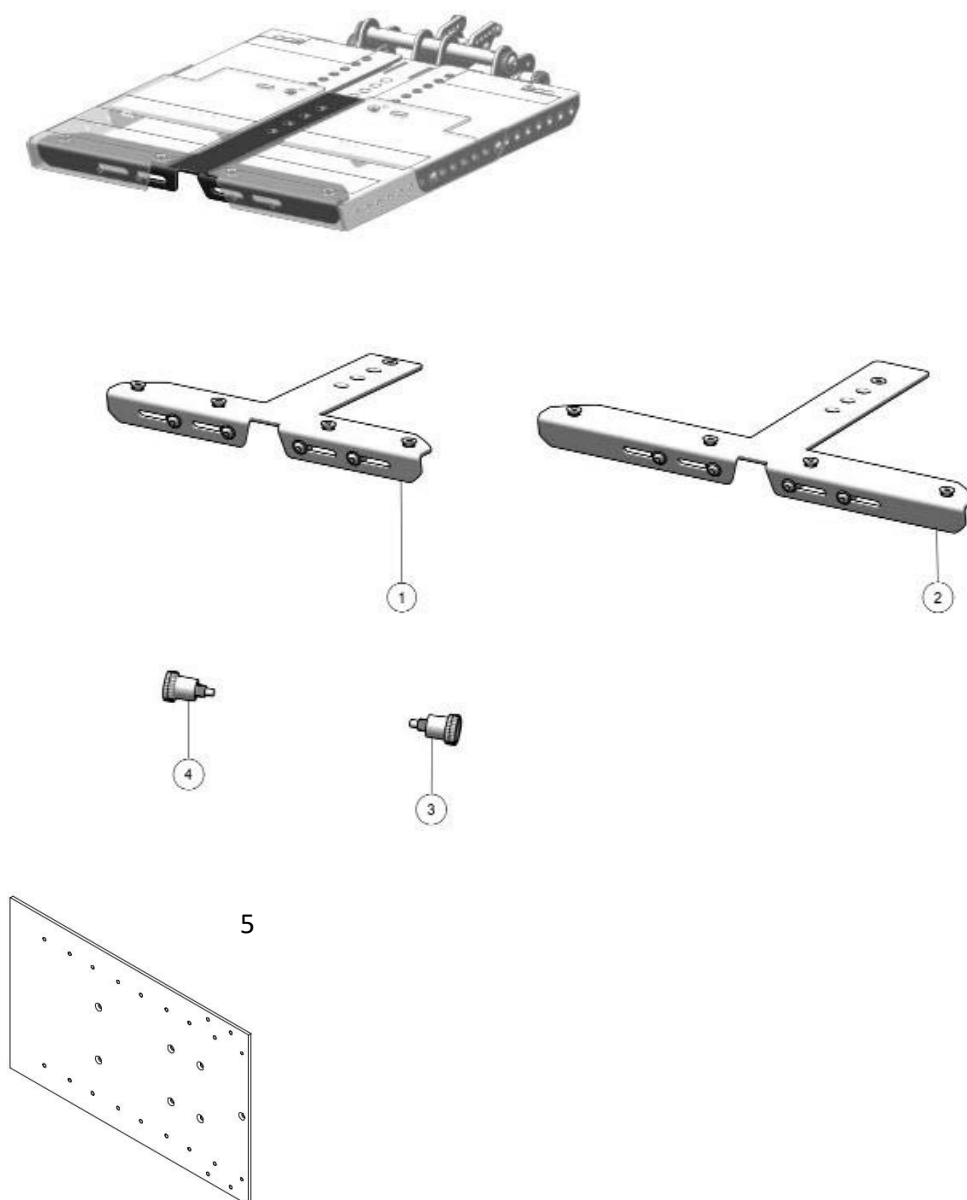

Spare part

1. Seat frame 10-12 diamond black
2. Seat frame 14-16 diamond black
3. Sprung lock, left
4. Sprung lock, right
5. Seat cross, upper part, Kameleon

Part number

37050000020
37050000021
42050000073
42050000074
10018978

Seat cushions, Kameleon

Seat Width \ Seat Depth	250 mm	275 mm	300 mm	350 mm	375 mm	400 mm
250 mm	①	③	③	/		
270 mm						
290 mm						
310 mm						
330 mm	②	④	④	⑤	⑦	
350 mm						
370 mm						
390 mm						
410 mm	/		④	⑥	⑧	
430 mm						
450 mm						

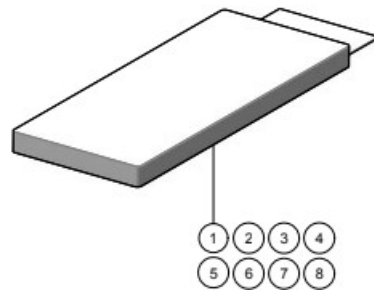

Spare part

1. Black Airmesh, single layer
2. Black Airmesh, single layer
3. Black Airmesh, single layer
4. Black Airmesh, single layer
5. Black Airmesh, single layer
6. Black Airmesh, single layer
7. Black Airmesh, single layer
8. Black Airmesh, single layer

See table above.

Part number

- 390400000169
- 390400000170
- 390400000171
- 390400000172
- 390400000173
- 390400000174
- 390400000175
- 390400000176

Support cushions, Kameleon

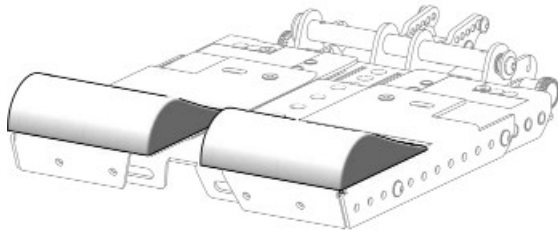

Seat Width		
Size 1	250mm	①
	275mm	
	300mm	②
Size 2	350mm	③
	375mm	
	400mm	④

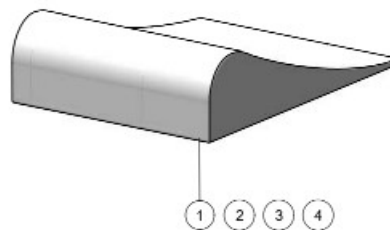

Spare part

1. Foam cushion, seat, size 250-275mm
1
2. Foam cushion, seat, size 300mm
1
3. Foam cushion, seat, size 350-375mm
2
4. Foam cushion, seat, size 400mm
2

Part number

- 171100000168
171100000169
171100000170
171100000171

See table above.

Knee support, Kameleon

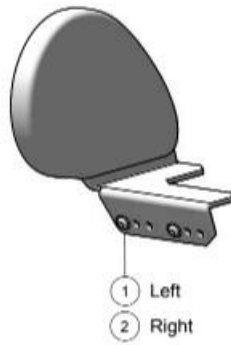
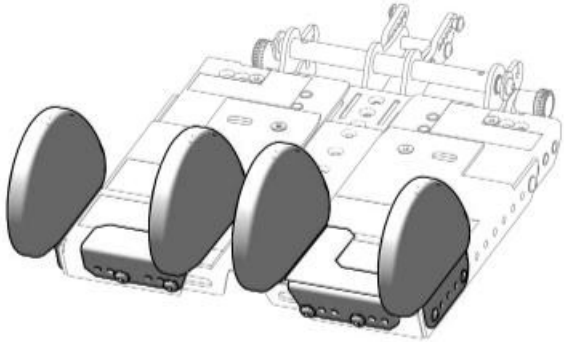

Spare part

1. Knee support, left, inner
2. Knee support, right, inner
3. Knee support, outer

Part number

390500000020
390500000021
390500000022

Hip support, Kameleon

Seat Width \ Seat Depth	250 mm	275 mm	300 mm	350 mm	375 mm	400 mm
250 mm	① ②			① ②		
270 mm						
290 mm						
310 mm						
330 mm	③			① ②		
350 mm						
370 mm						
390 mm						
410 mm	③			③		
430 mm						
450 mm						

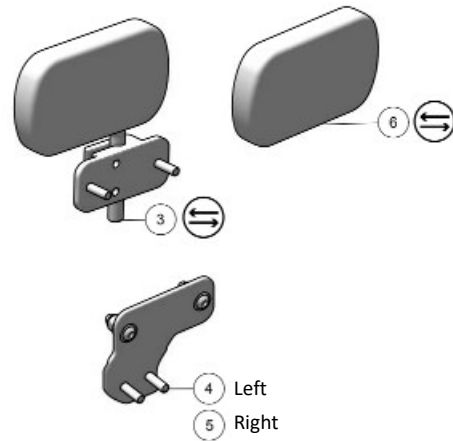

Spare part

1. Hip support, left, child 50-75
2. Hip support, right, child 50-75
3. Hip support, child 50-75
4. Extended bracket, left, diamond black
5. Extended bracket, right, diamond black
6. Hip cushion, Leon

Part number

- 390500000028
390500000029
390500000014
431000000001
431000000002
421000000092

See table below.

Back frame, Kameleon



11



12

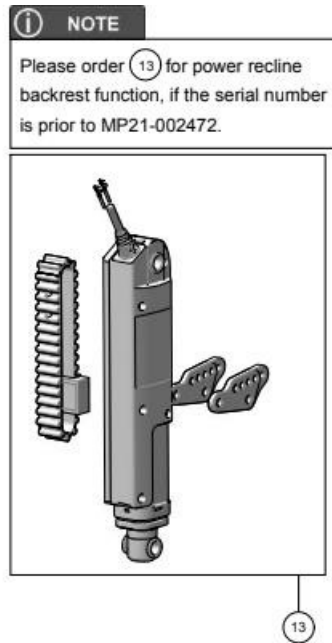

13

Spare part

Spare part	Part number
1. Back plate, size 1 250-300mm yellow	431200000001
2. Back plate, size 1 250-300mm rose red	431200000002
3. Back plate, size 1 250-300mm navy blue	431200000003
4. Back plate, size 1 250-300mm diamond black	431200000004
5. Back plate, size 1 250-300mm matte black	431200000005
6. Back plate, size 2 350-400mm yellow	431200000006
7. Back plate, size 2 350-400mm rose red	431200000007
8. Back plate, size 2 350-400mm navy blue	413200000008
9. Back plate, size 2 350-400mm diamond black	431200000009
10. Back plate, size 2 350-400mm matte black	431200000010
11. Back tilt, manual	190600000050
12. Back actuator, Leon F	421500000080

Upper back panel, Kameleon

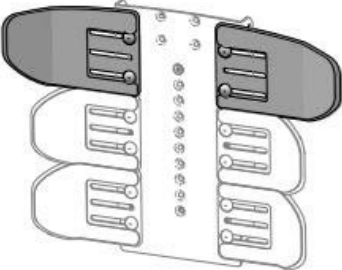

Standard Panel	Size 1	1	2	3	4	5
	Size 2	6	7	8	9	10
Shoulder Panel	Size 1	11	12	13	14	15
		16	17	18	19	20
	Size 2	21	22	23	24	25
		26	27	28	29	30

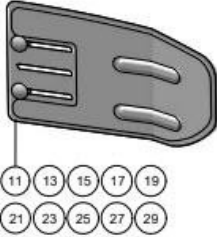
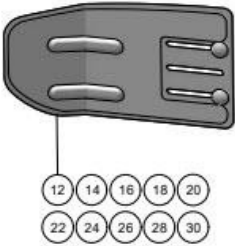
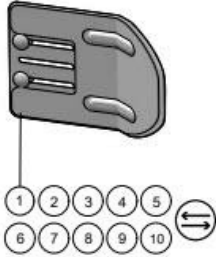

Upper back panel, Kameleon

Spare part	Part number
1. Back plate, standard size 1, yellow	391200000034
2. Back plate, standard size 1, rose red	391200000033
3. Back plate, standard size 1, navy blue	391200000032
4. Back plate, standard size 1, diamond black	391200000031
5. Back plate, standard size 1, matte black	391200000065
6. Back plate, standard size 2, yellow	391200000039
7. Back plate, standard size 2, rose red	391200000038
8. Back plate, standard size 2, navy blue	391200000037
9. Back plate, standard size 2, diamond black	391200000036
10. Back plate, standard size 2, matte black	391200000066
am	
.	
11. Shaft panel, left, size 1, yellow	391200000029
12. Shaft panel, right, size 1, yellow	391200000030
13. Shaft panel, left, size 1, rose red	391200000027
14. Shaft panel, right, size 1, rose red	391200000028
15. Shaft panel, left, size 1, navy blue	391200000025
16. Shaft panel, right, size 1, navy blue	391200000026
17. Shaft panel, left, size 1, diamond black	391200000023
18. Shaft panel, right, size 1, diamond black	391200000024
19. Shaft panel, left, size 1, matte black	391200000067
20. Shaft panel, right, size 1, matte black	391200000068
21. Shaft panel, left, size 2, yellow	391200000046
22. Shaft panel, right, size 2, yellow	391200000047
23. Shaft panel, left, size 2, rose red	391200000044
24. Shaft panel, right, size 2, rose red	391200000045
25. Shaft panel, left, size 2, navy blue	391200000042
26. Shaft panel, right, size 2, navy blue	391200000043
27. Shaft panel, left, size 2, diamond black	391200000040
28. Shaft panel, right, size 2, diamond black	391200000041
29. Shaft panel, left, size 2, matte black	391200000069
30. Shaft panel, right, size 2, matte black	391200000070

Centre panel, back, Kameleon

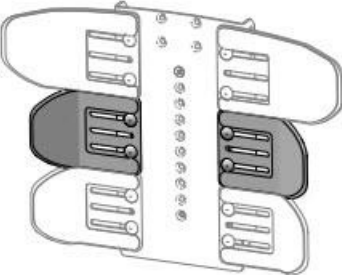

Standard Panel	Size 1	1	2	3	4	5
	Size 2	6	7	8	9	10
Lateral Panel	Size 1	11	12	13	14	15
	Size 2	16	17	18	19	20

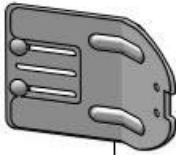
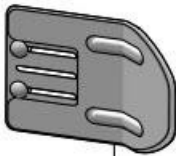

Centre panel, back, Kameleon

Spare part

	Part number
1. Centre panel, standard size 1, yellow	391200000034
2. Centre panel, standard size 1, rose red	391200000033
3. Centre panel, standard size 1, navy blue	391200000032
4. Centre panel, standard size 1, diamond black	391200000031
5. Centre panel, standard size 1, matte black	391200000065
6. Centre panel, standard size 2, yellow	391200000039
7. Centre panel, standard size 2, rose red	391200000038
8. Centre panel, standard size 2, navy blue	391200000037
9. Centre panel, standard size 2, diamond black	391200000036
10 am. Centre panel, standard size 2, matte black	391200000066
11. Centre panel, lateral, size 1, yellow	391200000052
12. Centre panel, lateral, size 1, rose red	391200000051
13. Centre panel, lateral, size 1, navy blue	391200000050
14. Centre panel, lateral, size 1, diamond black	391200000049
15. Centre panel, lateral, size 1, matte black	391200000063
16. Centre panel, lateral, size 2, yellow	391200000056
17. Centre panel, lateral, size 2, rose red	391200000055
18. Centre panel, lateral, size 2, navy blue	391200000054
19. Centre panel, lateral, size 2, diamond black	391200000053
20. Centre panel, lateral, size matte black	391200000064

Lower panel, back, Kameleon

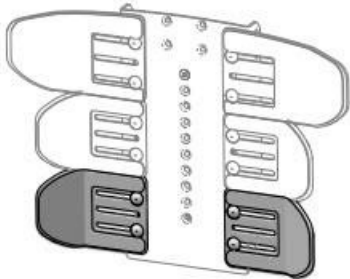

Standard Panel	Size 1	1	2	3	4	5
	Size 2	6	7	8	9	10

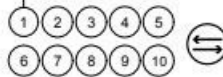
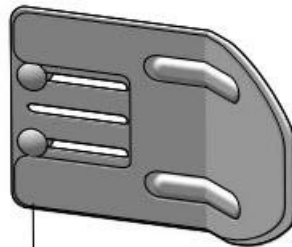

Spare part

1. Bottom panel, standard size 1, yellow
2. Bottom panel, standard size 1, rose red
3. Bottom panel, standard size 1, navy blue
4. Bottom panel, standard size 1, diamond black
5. Bottom panel, standard size 1, matte black
6. Bottom panel, standard size 2, yellow
7. Bottom panel, standard size 2, rose red
8. Bottom panel, standard size 2, navy blue
9. Bottom panel, standard size 2, diamond black
10. Bottom panel, standard size 2, matte black

Part number

391200000034
 391200000033
 391200000032
 391200000031
 391200000065
 391200000039
 391200000038
 391200000037
 391200000036
 391200000066

Back cushions, Kameleon

Back cushion	Cushions for Standard/Lateral Panel	Cushions for Shoulder Panel
Size 1	③	① ②
Size 2	⑥	④ ⑤

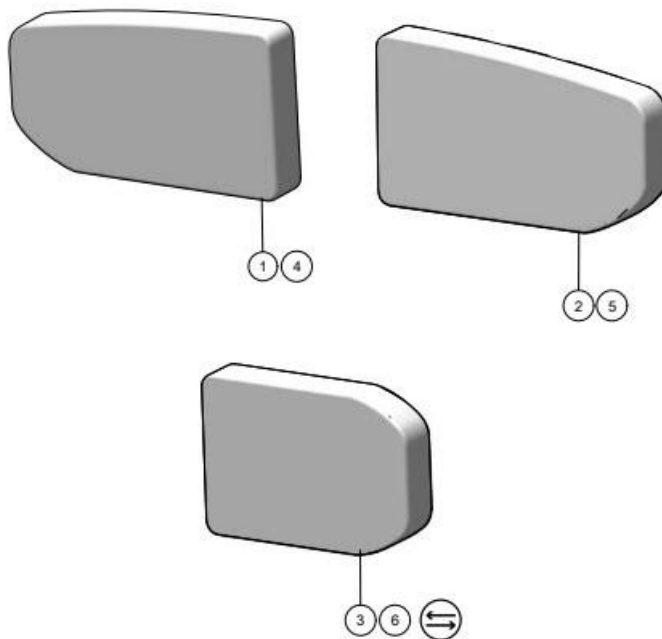

Spare part

1. Shaft cushion, size 1, right, black airmesh
2. Shaft cushion, size 1, left
3. Standard lateral cushion, size 1, black airmesh
4. Shaft cushion, size 2, right, black airmesh
5. Shaft cushion, size 2, left, black airmesh
6. Standard lateral cushion, size 2, black airmesh

Part number

- 390400000179
- 390400000178
- 390400000177
- 390400000181
- 390400000182
- 390400000180

Armrest, Kameleon

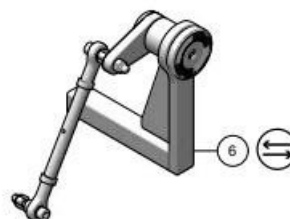
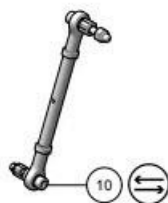
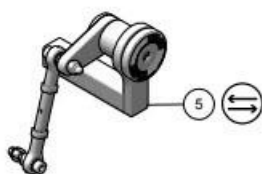
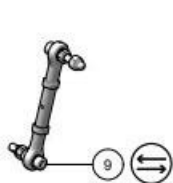
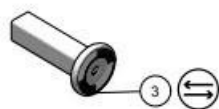
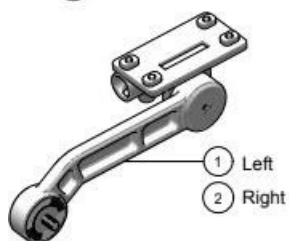
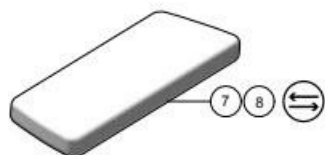

Spare part

1. Armrest, left
2. Armrest, right
3. Attachment, fixed armrest 250-300mm
4. Attachment, fixed armrest 350-400mm
5. Armrest linkage 250- 300mm
6. Armrest linkage 350- 400mm
7. Armrest cushion, 200L PU foam
8. Armrest cushion, 280L PU foam
9. Link arm 250- 300mm
10. Link arm 350-400mm

Part number

- 420800000176
- 420800000177
- 431400000001
- 431400000002
- 431400000003
- 431400000004
- 390300000041
- 390300000042
- 422500000009
- 422500000010

Leg rest, Kameleon

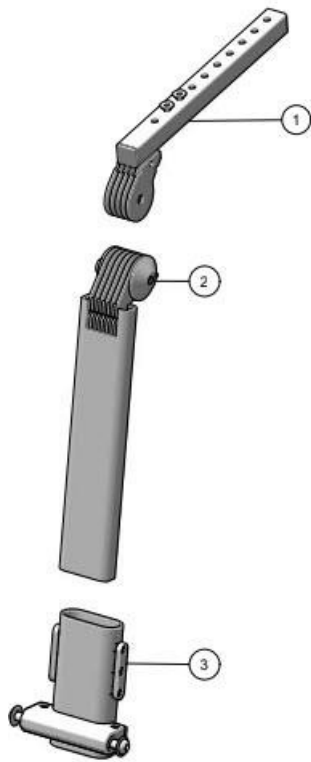

Spare part

1. Depth adjustment tube, Diamond black
2. Leg rest tube, upper section
3. Leg rest, lower section

Part number

- 420700000077
420700000078
420700000076

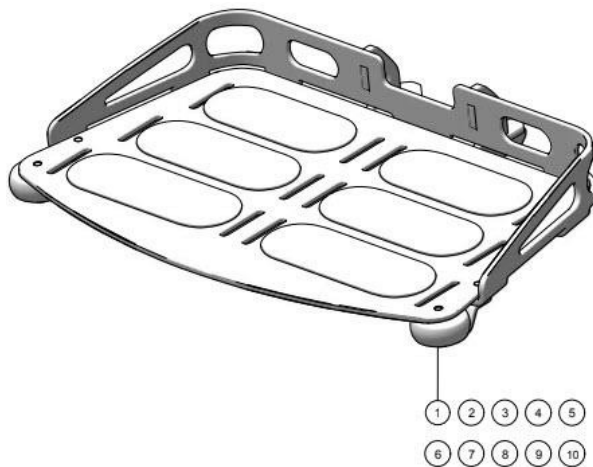

Footrest, Kameleon

Spare part

1. Footrest, aluminium 10-12", yellow
2. Footrest, aluminium 10-12", rose red
3. Footrest, aluminium 10-12", navy blue
4. Footrest, aluminium 10-12", diamond black
5. Footrest, aluminium 10-12", diamond black
6. Footrest, aluminium 14-16", yellow
7. Footrest, aluminium 14-16", rose red
8. Footrest, aluminium 14-16", navy blue
9. Footrest, aluminium 14-16", diamond black
10. Footrest, aluminium 14-16", diamond black

Part number

- 391600000007
391600000006
391600000005
391600000004
391600000008
391600000012
391600000011
391600000010
391600000009
391600000013

Reconditioning instructions

Eurovema Mobility products are intended to be reused during their expected service life.

Cleaning

Do not use high pressure washers, running water, or other liquids that may get into the electronics. Clean the chassis and other metallic and plastic components using a pH neutral detergent and a damp rag or cleaning cloth, e.g. WypAll or similar. Stuffed parts must be replaced or cleaned using a foam cleaner specifically intended for use on furniture if their condition so allows. Removable upholster covers are washable at 60°. Washing advice can be found on the sewn-in label. Touchable surfaces may be cleaned with disinfectants. Use only original Eurovema Mobility parts.

Chassis and wheels

Check that all wheels are in contact with the surface on which the wheelchair is operating. Wheel bolts must be tightened. If the bolts come loose, replace with new bolts and lock nuts. Check that the castors are undamaged and roll freely. The wheel fork must rotate without seizing. Also check that there is no play in fork pins/bearings. Test drive to check to ensure that none of the castors wobble at higher speeds. Check that the drive wheel screws are tightened and the tyres are not worn.

Brakes

Test drive the chair to make sure that it brakes as it should. Make sure that declutching works and that it is possible to move the chair manually without abnormal resistance. The chair must be powered down for this test. Test the magnetic brake microswitch by starting the chair with declutching activated. This should generate a fault code, which is indicated on the control device.

Lifting pillar

Check that the lifting pillar is secure and that all cables are undamaged and properly secured. Listen for any noise when the lift is operated for the full stroke. Test the lift under load from the bottom to the highest position. Test the half speed microswitch during the test drive. The speed of the chair should reduce when the seat is raised.

Electronics and batteries

Check that the correct software is installed and updated to the latest version. Test drive all chair driving profiles, activate seat functions, and ensure that they are working correctly for the full stroke. Charge batteries to full capacity and make sure that the charger switches over to trickle charging. Make sure that the batteries are secure and that the cables are firmly attached to the battery terminals. Test the main switch - should trip when the button is pressed.

Seat system

Correct seat system and combination. There must be no abnormal play in the seat cross, back support, armrests, or other accessories. Seat and back upholstery undamaged and clean. Removable upholstery covers can be washed at 60°. Check that the sewn-in washing advice label is still present. Test manual seat functions and adjustable accessories to ensure that they can operate without

seizing. Lubricate threads on all lock wheels/levers, and check that the wheels show no signs of burring. Belt holes must be free and the threads in functional condition.

Accessories

Make sure that leg rests and armrests can be adjusted without seizing and they they do not catch on covers in their lowest positions. Check the function and condition of all accessories. Lubricate all adjustable mountings.

Final check

Warning labels, CE mark with serial number must be legible. Final test drive. User manual with seat for new user.

Destruction instructions

Products that are decommissioned must be disassembled and their parts source sorted. Take appropriate precautions during the disassembly process as there is a risk of crush injury. Disassembly may only be carried out by an authorised technician.

Metal	Electronics	Combustible
Chassis	power module	Tyre
Seat cross	Control box	Cushions
Armrest mechanism	Control contacts	Castors
Back mechanism	Cables	Plastic covers
Seat lift	Time meter	Armrest cushions
Footrest		Belts
trunk support mechanism		Removable upholstery covers

Consumed batteries must be handed in to a recycling centre.

Reconditioning checklist

Chassis and wheels

- All wheels are in contact with the floor and are perpendicular.
- Wheel bolts are tightened and threadlocked.
- The wheels roll freely and turn easily.
- The wheels do not start to wobble at high speed.

Brakes

- Test of brakes and free braking mechanism. Cables lubricated.

Lifting pillar/lift actuators

- Secure and do not rotate. Lubricated with thin oil (Miniflex 500)
- Noise level low/no rattling (Miniflex 500)
- Lifts all the way up with the user sitting in the chair.
- Microswitch function test, well protected (Flexmobil i6)

Batteries and electronics

- The batteries are secure the the terminals well covered.
- All cables are well protected with shrink tubing and are not crushed.
- Test of ride electronics and charger. Charge batteries to full capacity.
- Correct drive program. The latest version of the program must be used.
- Time meter and main switch check. Correct size fuse.

Seat system

- Correct seat system and combination. No play
- Harness and safety belt holes present and free.
- Upholstery: Clean, washing label sewn on cover. Seams intact and undamaged.
- Seat angle and back support: function test.
- Electronic actuator does not fail under pressure.
- Wheels and dials: greased, easily adjusted and smooth knobs.

Accessories

- Leg rests: greased, easy to adjust, do not tear, and do not catch against the cover when seat height is adjusted.
- Functional check.
- Other accessories: greased, easily adjusted, not scratched.

Final check

- All extra equipment: fits and is easily adjusted.
 - Warning labels attached. CE marked with serial number.
 - Test operation (all functions tested in end positions and the wheelchair tested under maximum load)
 - User guide included and sent along with the product.
 - More information in the service manual
-

Electric wheelchair model: _____

Serial number: _____

Service carried out by:

Name: _____

Date: _____

Signature: _____

Eurovema

Eurovema AB
Baldersvägen 38, SE-332 35 Gislaved, Sweden
Tel./Phone +46 371 390 100 | Fax. +46 371 189 82
info@eurovema.se | www.eurovema.se